

1x2 Opto-Mechanical Switch

Feature

- Unmatched Low Cost
- Low Insertion Loss
- Epoxy-Free Optical Path
- High Reliability and Stability
- High Stability

Application

- Configurable Optical Networks
- Fiber Optic Instruments
- Optical Signal Routing
- Testing Instruments
- System Monitoring

Specification

Parameters	Unit	Single Window	Dual Window
Working Wavelength	nm	1260-1360 or 1510-1610	1310/1550+/-40
Insertion Loss	dB	≤0.8	≤1.0
Wavelength Dependent Loss	dB	≤0.25	≤0.30
Return Loss	dB	≥50	
PDL	dB	≤0.10	
Cross Talk	dB	≥55	
Switching Speed	ms	≤10	
Durability	cycle	≥10,000,000	
Repeatability	dB	≤+/-0.03	
Operating Voltage	V	3, 5	
Fiber Tensile Load	N	5	
Maximum Optical Power (CW)	mW	300	
Operating Temperature	°C	0~70	
Storage Temperature	°C	-40~85	

Note: 1. Specifications are for device without connectors; Specifications may change without notice.

2. To add connectors, IL is 0.3dB higher, RL is 5dB lower.

3. Devices for higher optical power or with other type fiber or consigned fiber are also available.

Package Dimensions

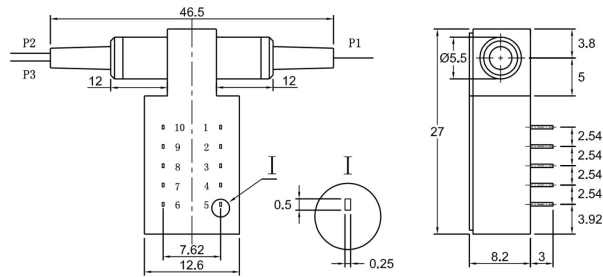

Latching Type:

Optical Path	Electrical Drive				Status Sensor			
	Pin 1	Pin	Pin 6	Pin	Pin 2-3	Pin	Pin 7-8	Pin 8-9
Path 1-2	NC	NC	GND	V+	Close	Open	Open	Close
Path 1-3	V+	GND	NC	NC	Open	Close	Close	Open

Non-Latching Type:

Optical Path	Electrical Drive				Status Sensor			
	Pin 1	Pin	Pin6	Pin	Pin 2-3	Pin	Pin 7-8	Pin 8-9
Path 1-2	NC	NC	NC	NC	Close	Open	Open	Close
Path 1-3	V+	NC	NC	GN	Open	Close	Close	Open

Ordering information

IOMS-	NNNN	-	NXN	C	(C)	-	C	NN	-	CC/CCC
Center Wavelength	Configuration n:		Latching:	Voltage/L			Fiber Sleeve	Fiber Length		Connector Type
1310= 1310nm	1X1= 1x1 Type		L= Latching	3=3V			B= 250um Bare Fiber	10=1.0m		N =Without Connector
1550= 1550nm	1X2= 1x2 Type		N=Non-Latching	Blankfor 5V			L= 900um Loose Tube	15=1.5m 20=2.0m		FC/APC=FC/APC Connector LC/PC =LC/PC connector